

## LE-410SI, TI, BI, HI

|                                                                                                  |             |                                      | 410SI | 410TI | 410BI | 410HI |
|--------------------------------------------------------------------------------------------------|-------------|--------------------------------------|-------|-------|-------|-------|
| Key Number                                                                                       | Part Number | Description                          |       |       |       |       |
| 1                                                                                                | 27352       | Flapper Valve                        | 1     | 1     | 1     | 1     |
| 2                                                                                                | 37351       | Injection Check Valve Body, PVC      | 1     | 1     | 1     | 1     |
| 3                                                                                                | 37341*      | Injection Check Valve Spring, H-C    | 1     | 1     | 1     | 1     |
| 4                                                                                                | 10338*      | Check Valve Ball, Ceramic, .375      | 1     | 1     | 1     | 1     |
| 5                                                                                                |             | Seal Ring                            |       |       |       |       |
| 6                                                                                                | 36307*      | Cartridge Valve, .375, PVDF/Polyprel | 3     | 3     | 3     | 3     |
| 7                                                                                                | 36103*      | Cartridge Valve O-Ring               | 3     | 3     | 3     | 3     |
| 8                                                                                                | 36107*      | Cartridge Valve Washer               | 3     | 3     | 3     | 3     |
| 9                                                                                                |             | Valve Seat                           |       |       |       |       |
| 10                                                                                               | 37203*      | Clamp Ring, SS                       | 3     | 3     | 3     | 3     |
| 11                                                                                               |             | Ferrule                              |       |       |       |       |
| 12                                                                                               |             | Clamp Sleeve                         |       |       |       |       |
| 13                                                                                               |             | Tubing Adapter                       |       |       |       |       |
| 14                                                                                               | 10411       | Coupling Nut, PP                     | 4     | 4     | 4     | 4     |
| 15                                                                                               | 10142-16    | Tubing, 1/2", PP                     | 1     | 1     | 1     | 1     |
| 16                                                                                               | 37769       | Valve Housing, PP                    | 3     | 3     | 3     | 3     |
| 17                                                                                               | 38059       | Multi-Function Valve, 3FV, PVC       |       | 1     |       |       |
|                                                                                                  | 38012       | Multi-Function Valve, 4FV, PVC       | 1     |       |       | 1     |
|                                                                                                  | 38015       | Multi-Function Valve, B4FV, PVC      |       |       | 1     |       |
| 18                                                                                               |             | High-Viscosity Spring                |       |       |       |       |
| 19                                                                                               | 31419*      | Liquifram, 3.0                       | 1     | 1     | 1     | 1     |
| 20                                                                                               | 36159       | Pump Head, Acrylic, 3.0              | 1     | 1     | 1     | 1     |
| 21                                                                                               | 10340*      | Pump Head Screw, SS                  | 4     | 4     | 4     | 1     |
| 22                                                                                               |             | Suction Tubing                       |       |       |       |       |
| 23                                                                                               | 36204       | Foot Valve Seat, PP                  | 1     | 1     | 1     | 1     |
| 24                                                                                               | 10123       | Foot Valve Screen, PP                | 1     | 1     | 1     | 1     |
| 25                                                                                               |             | High-Viscosity Valve Seat            |       |       |       |       |
| 26                                                                                               |             | H.V. Tubing Clamp                    |       |       |       |       |
| 27                                                                                               |             | H.V. Suction Tubing                  |       |       |       |       |
| 28                                                                                               |             | H.V. Tubing X 1/2 Connector          |       |       |       |       |
| 29                                                                                               | 38027       | Injection Check Valve Assembly       | 1     | 1     | 1     | 1     |
| 30                                                                                               |             | Discharge Valve Assembly             |       |       |       |       |
| 31                                                                                               | 38020       | Suction Valve Assembly               | 1     | 1     | 1     | 1     |
| 32                                                                                               | HALE410BI   | Pump Head Assembly                   |       |       | 1     |       |
|                                                                                                  | HALE410HI   |                                      |       |       |       | 1     |
|                                                                                                  | HALE410SI   |                                      | 1     |       |       |       |
|                                                                                                  | HALE410TI   |                                      |       | 1     |       |       |
| 33                                                                                               | 38033       | Foot Valve Assembly                  | 1     | 1     | 1     | 1     |
| 34                                                                                               | 37340*      | Injection Seat PTFE                  | 1     | 1     | 1     | 1     |
| 35                                                                                               | 10322       | Ceramic Weight                       | 1     | 1     | 1     | 1     |
| 36                                                                                               | 25636-10    | Return Line, 1/4", PP                | 1     | 1     | 1     | 2     |
| 37                                                                                               | 36260       | Cap ASM P/R (Black Knob)             | 1     | 1     |       | 1     |
| 38                                                                                               | 36280       | Cap ASM A/S (Yellow Knob)            | 1     |       | 1     | 1     |
| 39                                                                                               | 38061       | Multi-Function Valve Body, 3FV, PVC  |       | 1     |       |       |
|                                                                                                  | 38016       | Multi-Function Valve Body, 4FV, PVC  | 1     |       |       | 1     |
|                                                                                                  | 38016       | Multi-Function Valve Body, B4FV, PVC |       |       | 1     |       |
| 40                                                                                               | 25628       | Nut Multi-Function Valve             | 4     | 4     | 4     | 4     |
| 41                                                                                               | 25627       | Screw Multi-Function Valve           | 4     | 4     | 4     | 4     |
| 42                                                                                               | 25631       | Return Line Coupling Nut             | 1     | 1     | 1     | 1     |
| 43                                                                                               | 34876       | Adjustment Screw B/4FV               |       |       | 1     |       |
| 44                                                                                               | 32171       | Cap B/4FV                            |       |       | 1     |       |
| 45                                                                                               | 34868       | Plug B/4FV                           |       |       | 1     |       |
| 46                                                                                               | 32173       | Gasket B/4FV                         |       |       | 1     |       |
| 47                                                                                               | 32175       | Small O-Ring B/4FV                   |       |       | 1     |       |
| 48                                                                                               | 32176       | Large O-Ring B/4FV                   |       |       | 1     |       |
| 49                                                                                               | 38538       | Auto Prime Valve, Acrylic            |       |       |       | 1     |
| *Parts Included in <b>RPM-312/318 - Repair &amp; Preventative Maintenance Kit</b> ( Spare Parts) |             |                                      |       |       |       |       |
| Additional Parts Included in Kit:                                                                |             |                                      |       |       |       |       |
|                                                                                                  | 10973       | Shaft Seal                           | 1     | 1     | 1     | 1     |

# Liquid End Parts List

- 1 Flapper valve
- 2 Injection check valve body
- 3 Injection check valve spring
- 4 Check valve ball
- 5 Sealing ring
- 6 Cartridge valve
- 7 Cartridge valve o-ring
- 8 Cartridge valve washer
- 9 Valve seat
- 10 Clamp ring
- 11 Ferrule
- 12 Clamp sleeve
- 13 Tubing adapter
- 14 Coupling nut
- 15 Discharge tubing
- 16 Valve housing
- 17 Multi-function valve
- 18 High-viscosity spring
- 19 Liquifram
- 20 Pump head
- 21 Pump head screw
- 22 Suction tubing
- 23 Foot valve seat
- 24 Foot valve screen
- 25 High-viscosity valve seat
- 26 H.V. tubing clamp
- 27 H.V. suction tubing
- 28 H.V. Tubing x 1/2 NPT connector
- 29 Injection check valve assembly
- 30 Discharge valve assembly
- 31 Suction valve assembly
- 32 Pump head assembly
- 33 Foot valve assembly
- 34 Injection Seat PTFE
- 35 Ceramic Weight
- 36 Return Line
- 37 Cap ASM (Black Knob)
- 38 Cap ASM (Yellow Knob)
- 39 Multi-Function Valve Body
- 40 Nut Multi-Function Valve
- 41 Screw Multi-Function Valve
- 42 Return Line Coupling Nut
- 43 Adjustment Screw B/4-FV
- 44 Cap B/4-FV
- 45 Plug B/4-FV
- 46 Gasket B/4-FV
- 47 Small O-Ring B/4-FV
- 48 Large O-Ring B/4-FV
- 49 AutoPrime Valve

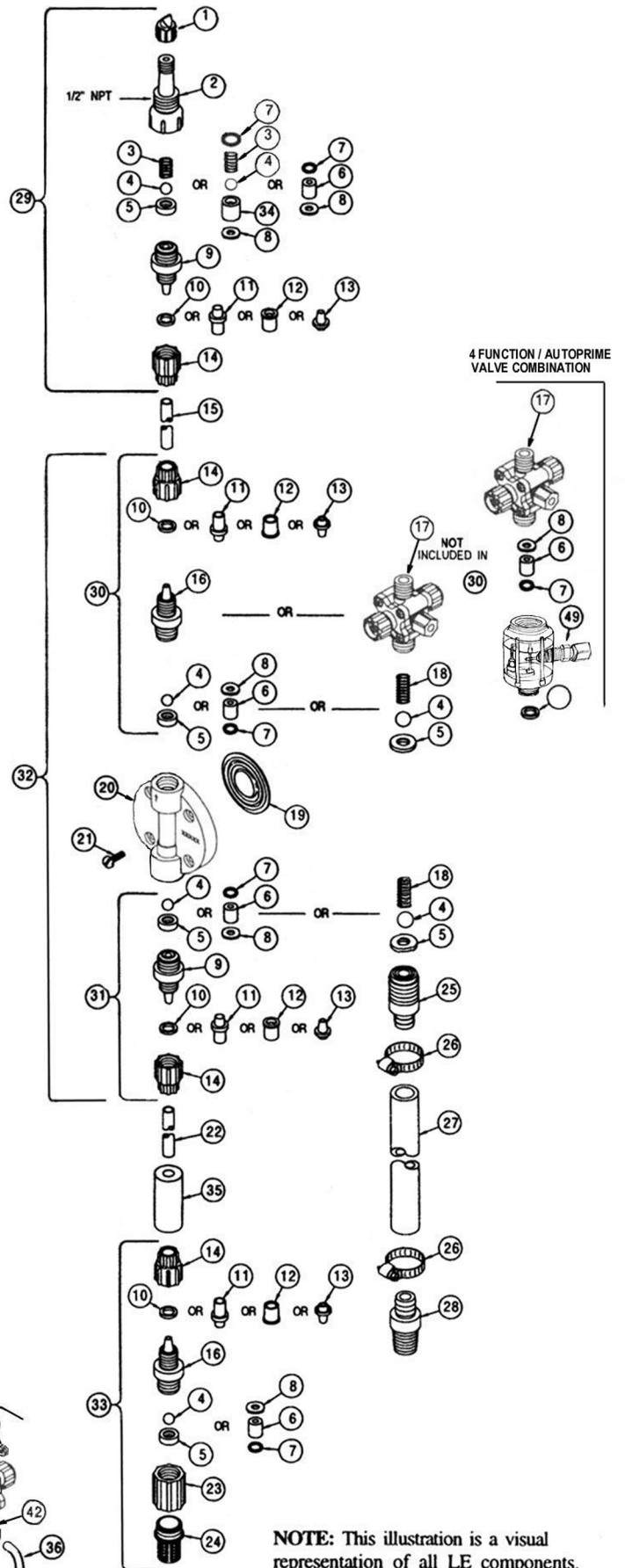

**NOTE:** This illustration is a visual representation of all LE components. Liquid ends will not include all parts shown.